

BIONIC TRIMMER



INSTRUCTIONS

For instructional videos & FAQ's visit highstreettv.com/support.

PARTS IDENTIFICATION

- If trimmer is dropped or subjected to a hard impact, liquid can be ejected from the battery. Should this liquid accidentally contact your skin, immediately flush the area with water as it can cause irritation and even burns. Should the liquid contact your eyes you will also need to seek medical attention.
- To prevent the risk of short circuit do not open the battery yourself.
- To prevent the risk of explosion protect the battery from heat, such as continuous sunlight or fire.
- To prevent the risk of explosion do not short-circuit the battery.
- If the battery becomes damaged due to improper use, vapour may be emitted. Should this happen get fresh air and consult a doctor should any respiratory complaint develop.

WARNING:

Always wear protective clothing like gloves, long pants, long sleeves, eyewear and face protection. Be careful of people, pets and children. Stop using the trimmer if people are close and wait until they pass. Trimmer should be cleaned after each use. Use only in dry conditions. Do not use on wet grass. Use only as directed.

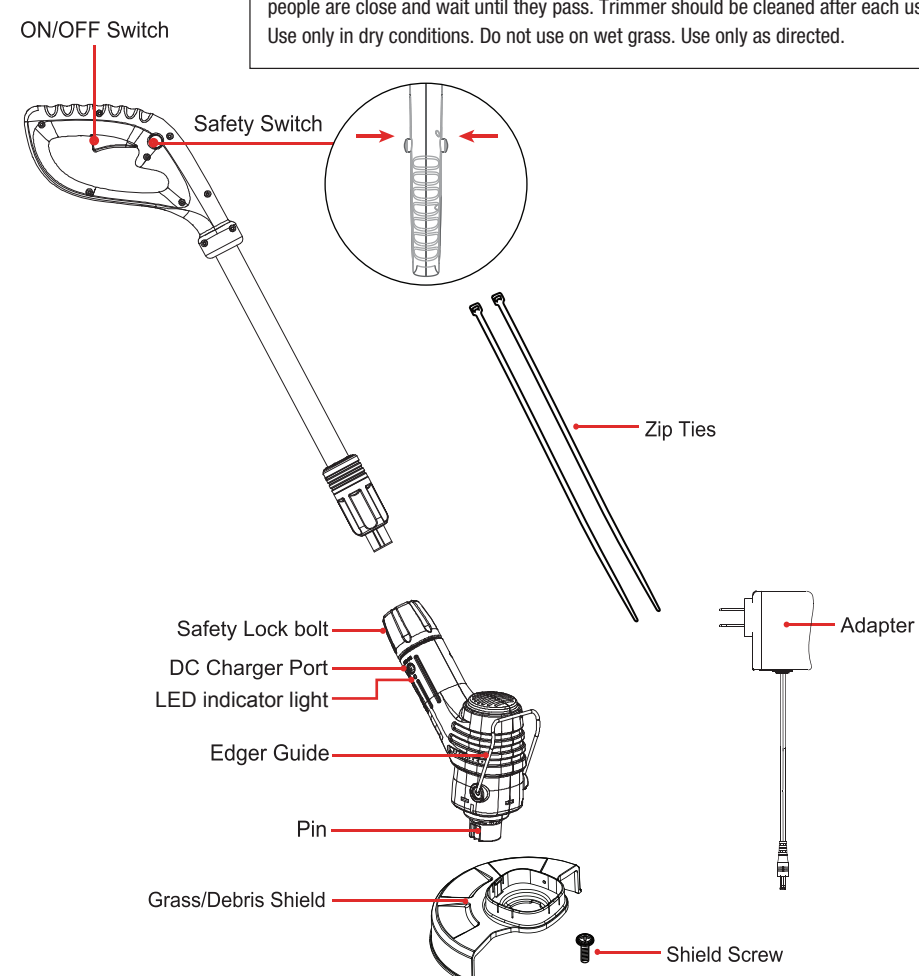

BEFORE USE - ASSEMBLY

UNPACKING

This product requires assembly.

1. Carefully remove the product and any accessories from the box. Make sure that all items are included:
 - Battery charger
 - Edger guide
 - Operating instructions
2. Inspect the product carefully to make sure no breakage or damage occurred during shipping.

WARNING: If any parts are damaged or missing, do not operate this product until the parts are replaced. Failure to heed this warning could result in serious personal injury.

ASSEMBLY

ASSEMBLING HANDLE WITH TELESCOPIC POLE

The telescopic pole is only designed for use with the Bionic™ trimmer at ground level. Do not use the trimmer with telescopic pole above ground level.

Assembling/adjusting the telescopic pole:

- a. Pull the telescoping pole out until the desired length has been reached. To lock pole in place, hold the main pole with one hand and twist the telescoping pole counter-clockwise with the other hand until tightened. If you need to adjust the length, twist the telescopic pole clockwise to unlock. Once finished, twist it counter-clockwise to lock.
- b. You can only adjust the length of the telescopic pole before you attach it to the trimmer.
- c. Align the grooves on telescopic pole (FIG.1) with the Lock Bolt (FIG. 2). Connect and push the pole all the way in the trimmer head in order for unit to work (FIG.3). Then tighten the lock bolt and twist clockwise until secure.
- d. To remove the telescopic pole, loosen the Safety Lock Bolt. Pull out the pole.

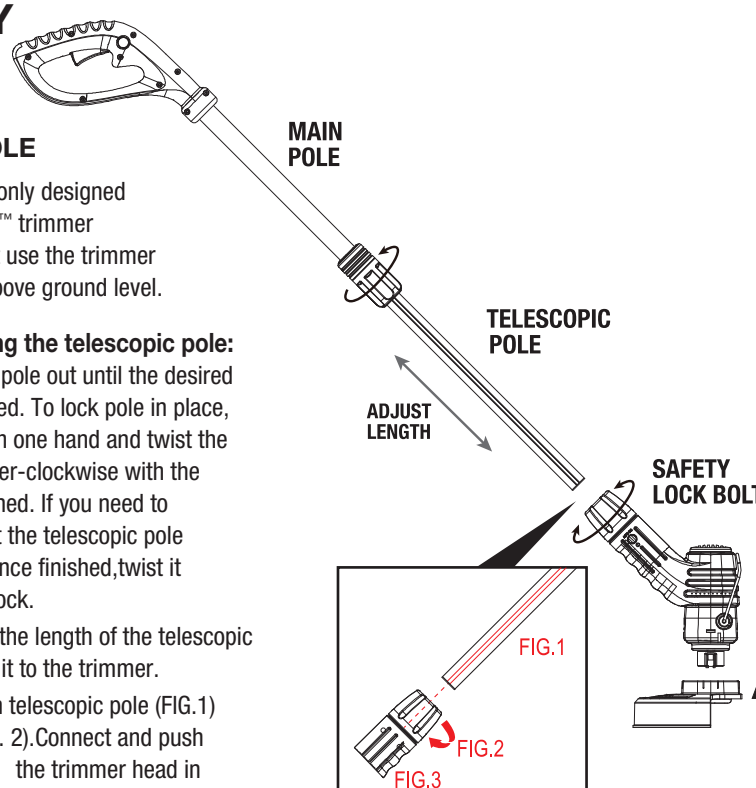

WARNING: Bionic Trimmer might not work for safety reason if the metal pole is not pushed all the way in.

ASSEMBLY

ASSEMBLING GRASS SHIELD

1. Align the tabs on the shield with the notches on the main body. Snap it on to attach. The plastic shield can be installed one way only.
2. Use the provided screw and secure the shield. Tighten the screw on the left side of the unit.

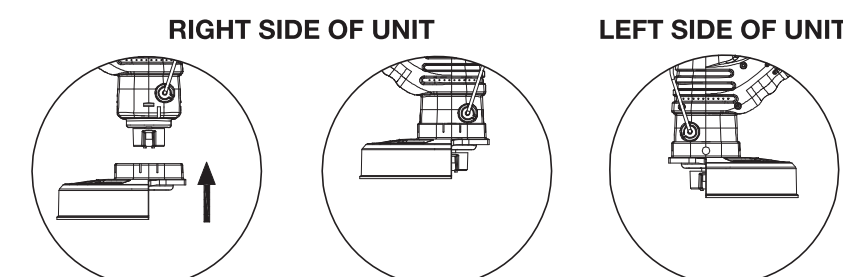

INSTALLING AND REPLACING ZIP TIES

Make sure the Bionic™ trimmer is turned off prior to installing or replacing zip ties.



The square case of the zip ties should face down, and the locking teeth should face up.

Insert the pointed end through the hole underneath the driver pin; then thread into the square case, pull till tight and locked securely.

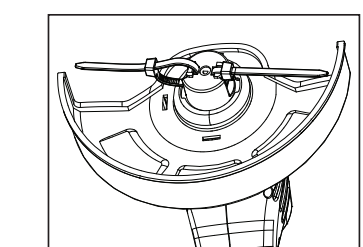

To replace new zip ties: cut down the worn ones, repeat the same steps to replace with new ones.

4. When replacing zip ties, cut down worn or damaged zip ties and replace with new ones. Follow the steps 1-3 above to install new zip ties.

CHARGING - USAGE

CHARGING

IMPORTANT: Make sure the Bionic™ trimmer is turned off prior to charging it.

1. Charge the unit using the provided adapter. The indicator light will turn from red to green once fully charged.
 2. It will take approximately 4 hours to fully charge.
- FOR FIRST TIME USE: You will need to charge the unit until the charging indicator turns green. All subsequent charges will require a full 4 hour period.
- During the charging process, the trimmer's body may warm up. This is normal.

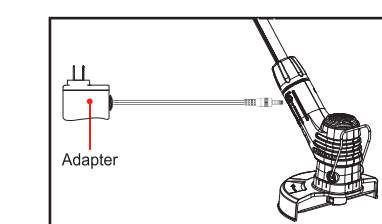

USAGE - GRASS TRIMMING

IMPORTANT! Before each use, check for damaged / worn parts and check zip ties for proper working condition.

Use the Bionic™ trimmer for trimming the edges of lawns and small areas of grass in private gardens and hobby areas.

VERY IMPORTANT! MAKE SURE YOU HAVE READ AND UNDERSTOOD ALL WARNINGS ON PAGES 7-8 OF THIS USER MANUAL PRIOR TO USING BIONIC™ TRIMMER.

MAKE SURE THIS IS DONE FIRST:

- Bionic™ Trimmer has to be fully charged. Refer to Charging instructions above. When the battery is drained, the trimmer will automatically turn off in order to protect the Lithium battery against deep discharging.
- If needed, extend telescopic pole to the desired length. Refer to p.2 (Assembling handle) with telescopic pole) for instructions.

Always hold the Bionic™ trimmer away from your body keeping clearance between the body and the trimmer. Any contact with the trimmer's zip ties during operation can result in serious personal injury.

- 1 TO TURN THE TRIMMER ON: While pressing and holding the Safety Lock, press the ON/OFF Switch. See Diagram on right.

- 2 Stand in a secure position with your weight evenly balanced over both feet. Keep a firm grip with both hands while in operation.

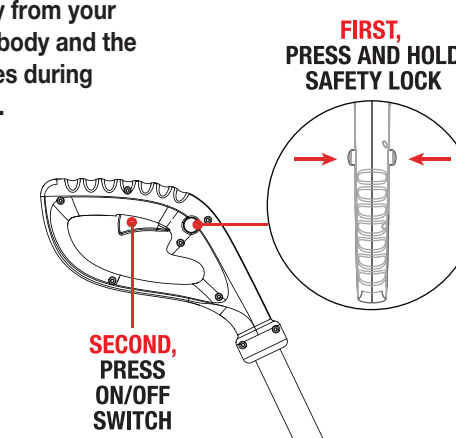

USAGE - EDGER

- 3 Move steadily along the line of cut, so that grass is fed directly into the cutting range.

If grass becomes wrapped around the trimmer:

- Stop the trimmer.
- Always wait until the zip ties stop moving.
- Remove the grass.
- Turn trimmer back on and continue trimming.

NOTE: Depending on the job, you may need to replace zip ties during trimming. Refer to p.3 for zip ties replacement instructions.

- 4 TO TURN THE TRIMMER OFF: Release the ON/OFF Switch.

USING AS EDGER:

FIRST - ASSEMBLE HANDLE/POLE FOR EDGER USE.

- 1 Loosen the Safety Lock Bolt by turning counter-clockwise. Pull the telescopic pole out. See Diagram 1 below.

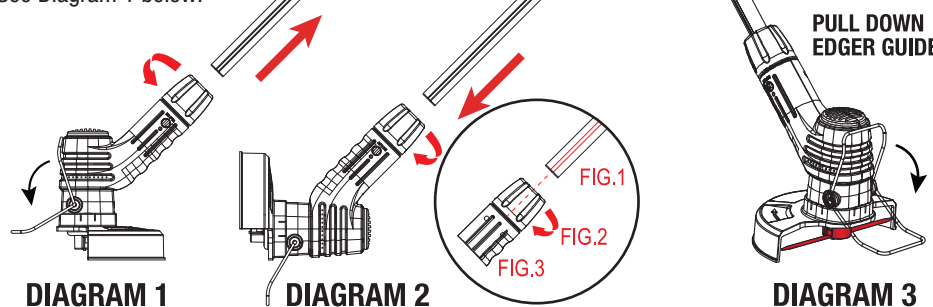

- 2 Turn the trimmer unit over. Refer to above Diagram 2 above. Align the grooves on telescopic pole (FIG. 1) with the Lock Bolt (FIG. 2). Connect and push the pole all the way in the trimmer head in order for unit to work (FIG. 3). Then tighten the lock bolt and twist clockwise until secure.

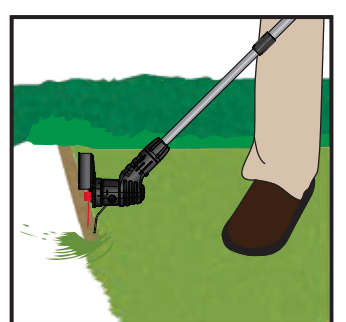
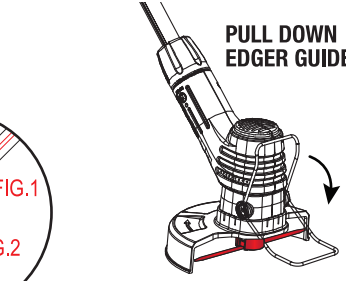

- 3 Pull edger guide down as shown on Diagram 3.
- 4 Trim the grass by moving along the edge as shown on right.

TIPS - MAINTENANCE - CLEANING/STORAGE

TIPS:

- Do not force the unit through dense growth and if the zip ties slow down, reduce your speed.
- Avoid trimming too close to dirt, sand or gravel, as this could damage zip ties and reduce the trimming efficiency.
- Do not allow the zip tie to contact paved surfaces, stones or garden walls, as this will rapidly wear down the zip ties.

MAINTENANCE

Spinning head/zip ties can cause injury. Make sure the switch is in the OFF position during maintenance work.

Note: To ensure long and reliable service, regularly perform the following maintenance:

- Check for obvious defects such as a damaged/loose zip ties or parts.
- If the trimmer should stop working properly, repair should be carried out by your authorized service agent.

CLEANING/STORAGE

Make sure the Bionic™ trimmer is turned off prior to cleaning.

- Clean the exterior of the trimmer thoroughly using a soft brush and cloth. Do not use water, solvents or polishes.
- Remove all debris especially from the ventilation slots.
- Charge the battery 4 hours before storing.
- During storage, charge the battery at least once every three months to protect it from damage.
- Store the trimmer in a dry, secure place out of reach of children.
- Do not place any other objects on top of the trimmer.
- The trimmer must not be stored over 35°C (95°F) or under direct exposure to sunlight.
- Do not store the trimmer in places with static electricity.



Avoid hitting on hard objects, i.e. stones, bricks, tree trunks, etc.

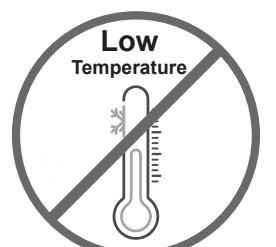

Avoid operating in low temperature, zip ties might become stiffened and easy to break.

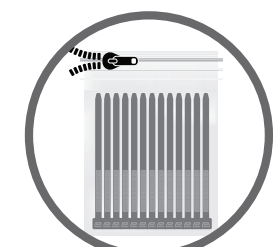

Zip ties are sensitive to low temperature and humidity, fasten bag securely after use.

IMPORTANT SAFETY INSTRUCTIONS

WARNING!

Read and understand all instructions. Failure to follow all instructions listed below may result in electric shock, fire and/or serious personal injury.

WARNING! PERSONAL SAFETY

- Before adjusting or cleaning the Bionic™ trimmer, make sure that the trimmer is turned off.
- When in use, keep all parts of your body away from the cutting range. Do not remove cut material or hold material to be cut when the zip ties are spinning.
- Once the Bionic™ trimmer has been turned off, the zip ties will continue to run for a short time. To prevent injury, keep your hands away from the moving zip ties.
- Inspect the work area before each use. Remove all foreign objects (rocks, wire pieces, broken glass, etc.) from grass. It can result in foreign objects being thrown into eyes/face, which can cause severe eye damage.
- Before beginning trimmer operation, always wear safety goggles or safety glasses with side shields and a full-face shield when needed. We recommend the use of a Wide Vision Safety Mask for use over glasses or standard glasses with side shields. Do not wear everyday glasses as those will not prevent an eye injury.
- To prevent the risk of injury, wear heavy, long pants, boots, and gloves. You can also wear hardhat, earmuffs and dust mask when required.
- Do not wear loose clothing or jewellery when operating the trimmer, as these could become caught in the spinning parts. If you have long hair keep it tied back above shoulder height.
- Do not operate the trimmer while barefoot or when wearing sandals or similar lightweight footwear.
- To maintain full control of the trimmer, keep a proper footing at all times with your weight evenly balanced over both feet and never overreach.
- Be alert and do not operate the trimmer when you are tired, ill, or under the influence of alcohol, drugs, or medication.
- Use this trimmer in daylight or good artificial light only.
- Make sure the power switch is off when clearing jammed material. A moment of inattention while operating the trimmer can result in serious personal injury.
- Carry the trimmer by the handle with the spinning head stopped.
- Only switch the motor on when your hands and feet are away from the cutting range.
- Always disconnect the trimmer from the power supply whenever the following conditions apply:
 - Whenever leaving the trimmer unattended.
 - Before clearing a blockage.
 - Before checking, cleaning or working on the unit.
 - After striking a foreign object.
 - When ever the trimmer starts vibrating abnormally.
- Always ensure that the ventilation openings are kept clear from debris.

IMPORTANT SAFETY INSTRUCTIONS

WARNING!

- Prior to using the Bionic™ trimmer, always check to ensure that all parts are properly assembled.
- Do not use the trimmer for other than its intended use.
- Do not allow children or untrained individuals to use this trimmer.
- Keep the trimmer's handle dry, clean and free from oil and grease.
- Keep all bystanders, children, and pets at least 50 ft. away.
- Make sure the power rating on the AC adaptor matches the outlet.
- Never modify AC adaptor on any way.
- Do not use any adaptor plugs with earthed (grounded) trimmers. Unmodified plugs and matching outlets will reduce risk of electric shock.
- Do not operate trimmers in the presence of flammable liquids, gases, dust or other explosive atmospheres. Trimmers create sparks which may ignite the dust or fumes.
- To prevent the risk of electric shock avoid body contact with grounded surfaces, such as pipes, radiators, ranges, refrigerators.
- Never use the power cable for carrying, pulling or unplugging the trimmer.
- To prevent the risk of electric shock, do not expose trimmer to rain or wet conditions.
- This product is intended for light trimming. Please note that this trimmer is not designed for commercial, trade or industrial use.
- Do not use the trimmer if the power switch is faulty. Any trimmer that cannot be controlled with the switch is dangerous and must be repaired.
- To prevent the risk of accidentally starting the trimmer, make sure the trimmer is disconnected from the mains power supply before making any adjustments, changing accessories, or storing the trimmer.
- Trimmer is dangerous in the hands of untrained users. When not in use, store the trimmer out of the reach of children and do not allow persons unfamiliar with the trimmer (or these instructions) to operate it.
- To prevent the risk of accidents, periodically check the trimmer for misalignment, spinning parts, breakage of parts and any other condition that may affect the operation of the trimmer.
- Keep the trimmer clean. Use the trimmer and accessories in accordance with these instructions. Use of the trimmer for jobs for which it was not intended could result in injury.
- To ensure that the trimmer is safe, have it serviced at an authorized service agent.
- Save all warnings and instructions for future reference.

BATTERY/ BATTERY CHARGER SAFETY WARNINGS

- To prevent the risk of electric shock, protect the battery charger from rain and moisture.
- Recharge the battery only with the charger provided. A charger that is suitable for one type of battery pack may create a risk of fire when used with another battery pack.
- The supplied battery charger is only suitable for charging the trimmer and to prevent the risk of fire and explosion, it must not be used for charging any other trimmer.
- Before each use, check the battery charger, cable and plug for signs of damage. If the battery charger is damaged, do not use it or attempt to repair it instead take it to your local service agent for repair as damaged battery chargers, cables and plugs increase the risk of electric shock.
- To prevent the risk of fire, do not operate the battery charger on flammable surfaces (e.g. paper, textiles, etc.) or in combustible environments.

DISPOSAL - SPECIFICATIONS

DISPOSAL

Trimmer, accessories and packaging should be sorted for environmentally friendly recycling.

Battery packs/batteries:

This product contains a lithium-ion battery. Do not dispose of battery packs/batteries into household waste, water or fire. Battery packs/batteries must be collected, recycled or disposed of in an environmentally-friendly way. Please dispose of them properly at a public recycling centre.

1. Discharge lithium-ion battery completely.
2. Dispose of lithium-ion battery properly.



Batteries are best suited for battery-powered electric appliances, according to the state of the art. Li-Ion batteries are harmful to the environment if disposed of with other household waste.

PRODUCT SPECIFICATIONS

Item: Bionic™ Trimmer
 Battery pack voltage: 7.4V
 Battery pack capacity: 2000mAh
 Battery type: Lithium Battery
 Speed: 10000 RPM
 Noise level: 95 dB
 Maximum watts: 68W
 Charger (adaptor) input: DC9.5V 600mA
 Battery Charging time: 4 hours

Need help? We're here for you.

Please contact our Customer Services Team on:
 Phone: 0344 800 0631 (UK) / 0412 132 998 (Ireland)
 Email: customer@highstreettv.com
 For instructional videos & FAQ's visit highstreettv.com/support.



www.highstreettv.com

Distributed by:
HSTV Corby P.O. Box 7903
CORBY NN17 9HY



01/2021 CR2696 Bionic Trimmer IM